

A VISION
AHEAD

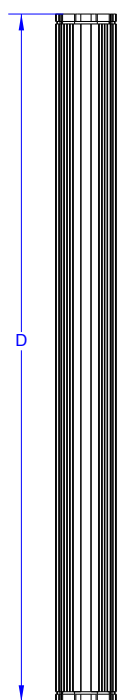

D	Di	X	CC
92	3.62	64	0.18
119	4.68	91	0.24
146	5.75	118	0.3
173.5	6.83	145	0.36
200.5	7.89	172	0.42
227.5	8.96	199	0.48
255	10.04	227	0.54
282	11.1	254	0.6
309	12.16	281	0.66
336	13.23	308	0.72
363	14.29	335	0.78
390.5	15.37	362	0.84
417.5	16.44	389	0.9
444.5	17.5	416	0.96
471.5	18.56	443	1.02
498.5	19.63	470	1.08
525.5	20.69	497	1.14
554	21.81	526	1.2

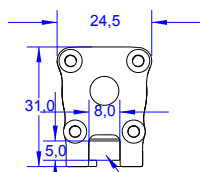

For mounting using M4 screws

Linear lights by PHLOX® offer the **best life cycle**, the **best chromaticity stability** and the **best luminance on the market**, all in an ultra compact aluminium body. PHLOX® is the only manufacturer to provide uniformity and luminance datas on the quality control seal positioned at the back of every light.

DESIGNED FOR YOUR APPLICATION

High speed inspection (glass and plastic)
Linear inspection of reflective materials
Web inspection
Linear inspection of transparent materials
Large surface inspection
Quality control with transparency.

& YOUR INDUSTRIAL SECTOR

Glassmaking
Pharmaceutical/Cosmetics
Automotive
Agribusiness
Electronics
Aeronautics and space.

HOW TO READ THE PRODUCT KEY

Manufacturer	Source colour	Light Output Area/Length	Range	Input voltage
PHLOX	- LEDW	- LINEAR -	X	- 31X24.5 - LLUB - 1R - CUR
Source type	Product type	Profile size	Number of light sources' rows	

PHLOX® EXCLUSIVE LIGHT PROCESS

NEW !

White led Linear light range

LESS THAN 20% LUMINANCE LOSS AFTER 100 000 HOURS (*)
LESS THAN 10% CHROMATICITY SHIFT AFTER 100 000 HOURS (*)

PHLOX - LEDW - LINEAR - **X** - 31X24.5 - LLUB - 1R - CUR

Illumination

Luminance minimum **≥320 000 cd/m² continuous mode**
Uniformity minimum **≥90% (+/- 10%) (X x4mm)**
Source Type **White LED**
Colour Temperature 5700°K (+/-500)
Light Angular Distribution 15° 1/2 angle
Expected Life **> 100 000 hours**

Electrical

Input Current (DC) **CC (Amps ±5%)**
Cable length 0.6 M - Ø 3.7 mm (2 ft - Ø 0.14")
Connector None
Cable pinout **+**
CE Conformity Yes
Strobe mode max 3 times CC for 10 ms pulse with 1/10 duty ratio

Outer unit

L x W x H **D x 31 x 24.5mm (Di x 1.22 x 0.96")**
Housing Material Black Anodized Aluminium
Weight From 86g (3 oz) up to 336g (11.85 oz)
Mounting Mounting with M4 screws

Environmental

Max. Operating Humidity 95% non-condensing
Operating Temperature 50°C (122°F) max
Storage Temperature 60°C (140°F) max
Shelf life 12 months from date of purchase
Max.temp.on housing +80°C (+176°F)

IP40 (IP65 on request)

Do not cover the light when it's switched on.

Accessories

LED Dimmer: 28V-5A very compact and easy to use
Product key: PHLOX DIM LIGHT

Power supply: 110V and 220V
Product key: ALIM-24V-2.5A60WEU or ALIM-24V-2.5A60WUS

LED Strober: 28V - 5A (up to 40A in pulse mode)
Pulse width between 2µs and 10ms
Product key: PHLOX STROBE LIGHT

area of temperature measurement
30mm all along the edges of the back of
the black anodized aluminium housing
(see image)

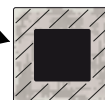

RoHS directive compliant

CLASS 1: Low RISK (CIE S2009:2002/NF EN 62471)

Each PHLOX Linearlight is provided with:
- 24 months warranty
- Certificate of uniformity and luminance
- Seal of quality on the back

May 11, 2022